



Lone Pine Court

Brixworth, Northamptonshire

oriordanbond
SALES & LETTINGS



Floor Plan

Approx. 56.2 sq. metres (605.0 sq. feet)

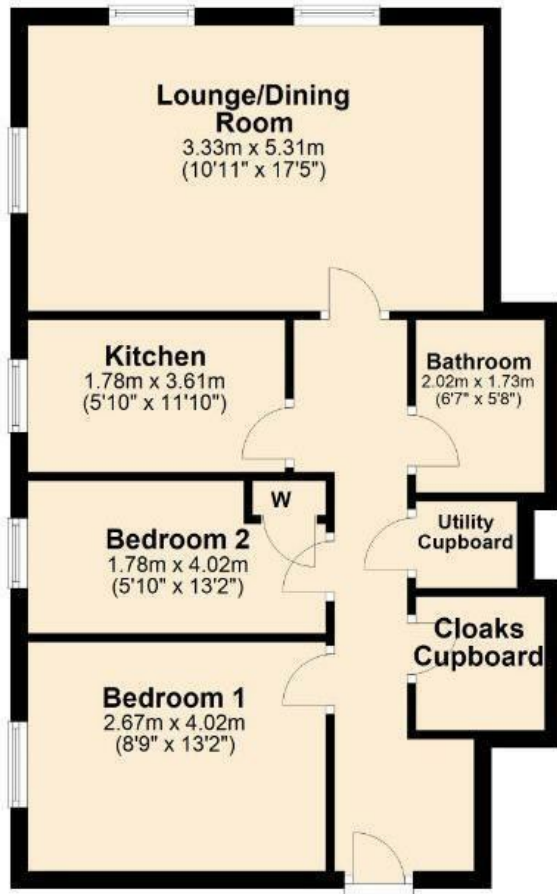

Total area: approx. 56.2 sq. metres (605.0 sq. feet)

Lone Pine Court

Brixworth

NN6 9EH

PRICE £150,000

A beautifully presented two bedroom ground floor apartment overlooking the green on the popular Lone Pine Court development within the thriving village of Brixworth. The property has gas radiator heating and is uPVC double glazed.

Offered with no onward chain, the accommodation comprises communal entrance hall with security entry system, entrance hall with large storage cupboard and further utility cupboard which currently houses the washing machine and tumble dryer, spacious sitting/dining room with picture window overlooking the green, modern kitchen with fitted oven and hob, two bedrooms and a modern shower room with ample storage space. Outside are well tended communal gardens and a garage situated in a block nearby. (A/605/-)

Additional information

- Council Tax Band: A
- Energy Efficiency Rating: C

Viewing

Viewing strictly by appointment – details below

Disclaimer

O'Riordan Bond Estate Agents Limited has not tested apparatus, equipment, fittings or services and so cannot verify they are in working order. The buyer is advised to obtain verification from their solicitor or surveyor.

O'Riordan Bond Brixworth Sales

01604 880077

brixworth@oriordanbond.co.uk

